

**Code: N-RKPP-EXT**

1" extension kit for the distributor, with flow meter

<https://www.ferrocompany.com/product-6590-NRKPPEXT.html>

Individual packaging: **1, package with bar code allowing for retail sale**

Collective packaging: -

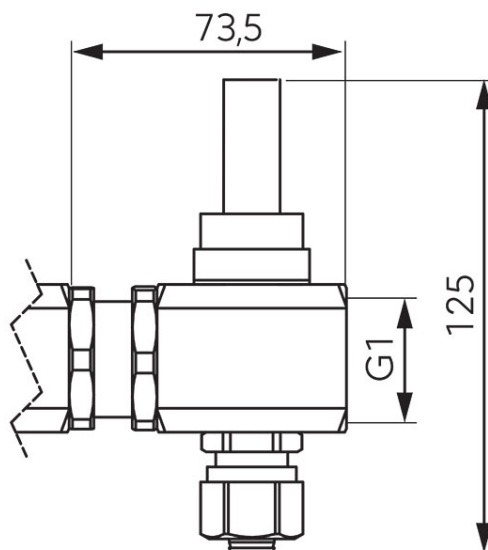

- flow meter for regulating flows on the beam supply, range 0-5 l/min
- G1/2 nipple with a connector for a 16x2 mm multilayer pipe
- 1" nipple with seal included