

Code: KFMF2SGK

Angle ball valve with butterfly placed under the body and 3/4 half-union, female-male

<https://www.ferrocompany.com/product-6556-KFMF2SGK.html>

Individual packaging: **1, package with bar code allowing for retail sale**

Collective packaging: **8**

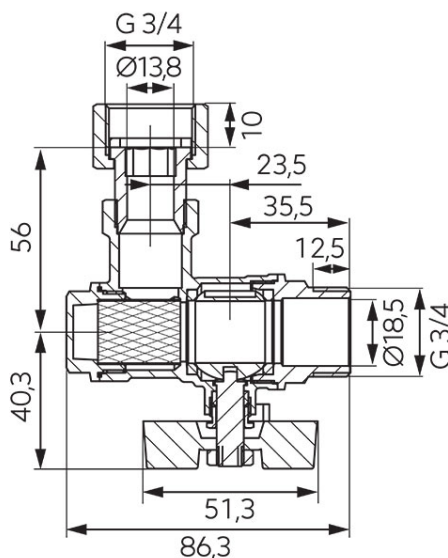
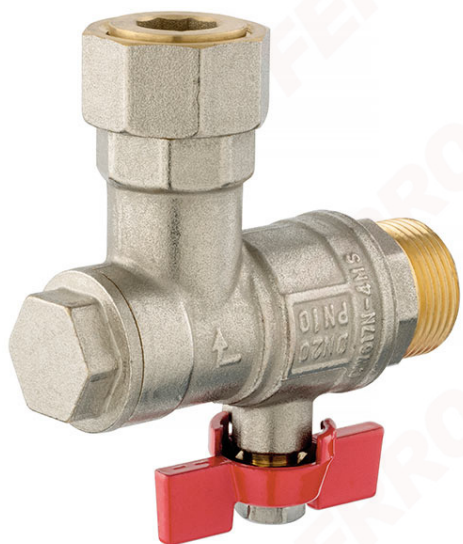

- NICKEL FREE - all product elements which may have contact with potable water are not covered with nickel
- CW617N-4MS brass - the latest hygienic standard
- media valves: water, glycol 50%
- female-male with half-union
- with gland
- handle: metal butterfly type placed under the body
- body and ball material: brass
- material of ball and stem seals: PTFE
- material of flat seals: EPDM
- material of filter: stainless steel
- nominal pressure: 10 bar
- maximum working temperature: 100°C