

Code: **Z29x-G**

Angle valve with ceramic head and rosette

<https://www.ferrocompany.com/product-6487-Z29xG.html>

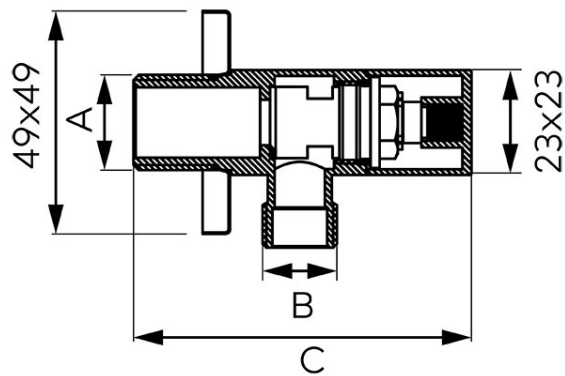

- ceramic head
- no contact of flowing water with paint finish
- the valve body doesn't scratch the rosette during installation
- nominal pressure: 1,0 MPa (10 bar)
- max. working temperature: 100°C
- finish: gold, PVD coating

Index	A	B	C [mm]	Connection dimensions
Z293-G	1/2"	3/8"	75	1/2"x3/8"
Z294-G	1/2"	1/2"	75	1/2"x1/2"