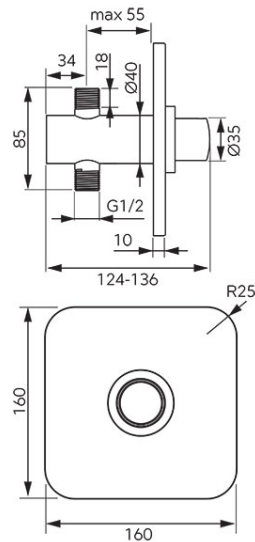

**Code: Z503SQ**

Presstige Pro - built-in shower valve with time flow control

<https://www.ferrocompany.com/product-6371-Z503SQ.html>Individual packaging: **1, package with bar code allowing for retail sale**

- Anti Vandal System - securing the rosette against unauthorized disassembly
- flow time factory setting: 30 s.
- outflow time: adjustable from 25 - 35 s
- min. water flow at dynamic pressure of 0.3 MPa (3 bar): 11 L/min.
- max. water temperature: 90°C
- recommended water temperature: 65°C
- recommended dynamic pressure range:  $0,1 \text{ MPa} \leq P \leq 0,5 \text{ MPa}$
- max. static pressure: 1 MPa (10 bar)
- flow time at dynamic pressure 0.3 MPa (3 bar): Regulated 30 + 5/-10 s
- starting force (button push): up to 41 N
- water inlet connection 2 x G1/2 MT